

REVISIONS		
DATE	NAME	LIC. NO.
07/30/06	RICHARD A MORALLE, P.E. & P.L.S.	GB25863

SEE SHEET 44

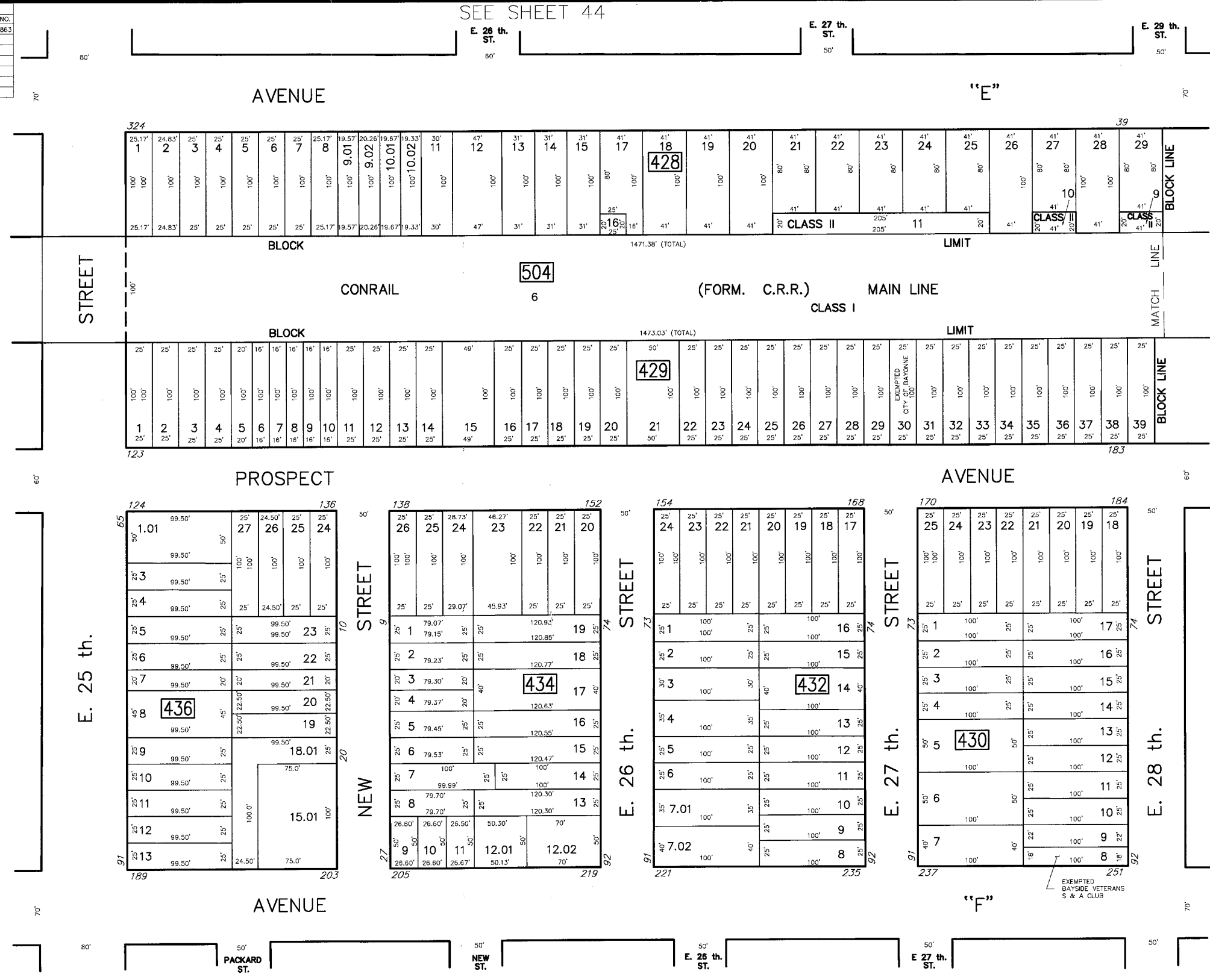
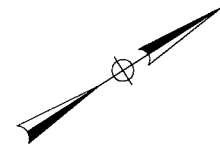

SEE SHEET 110

SEE SHEET 114

SEE SHEET 111

SEE SHEET 113

TAX MAP
 CITY OF BAYONNE
 HUDSON COUNTY, NEW JERSEY
 SCALE: 1" = 50' AUGUST, 2003
 RICHARD A. MORALLE, P.E., P.L.S.
 T & M ASSOCIATES
 11 TINDALL ROAD, MIDDLETOWN TOWNSHIP
 NEW JERSEY, 07748