

# TAX MAP

SHEET 61

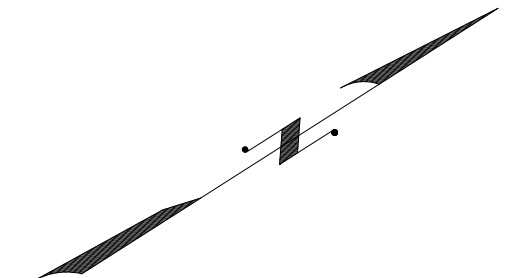

SHEET 67

SHEET 57



AVENUE "A"

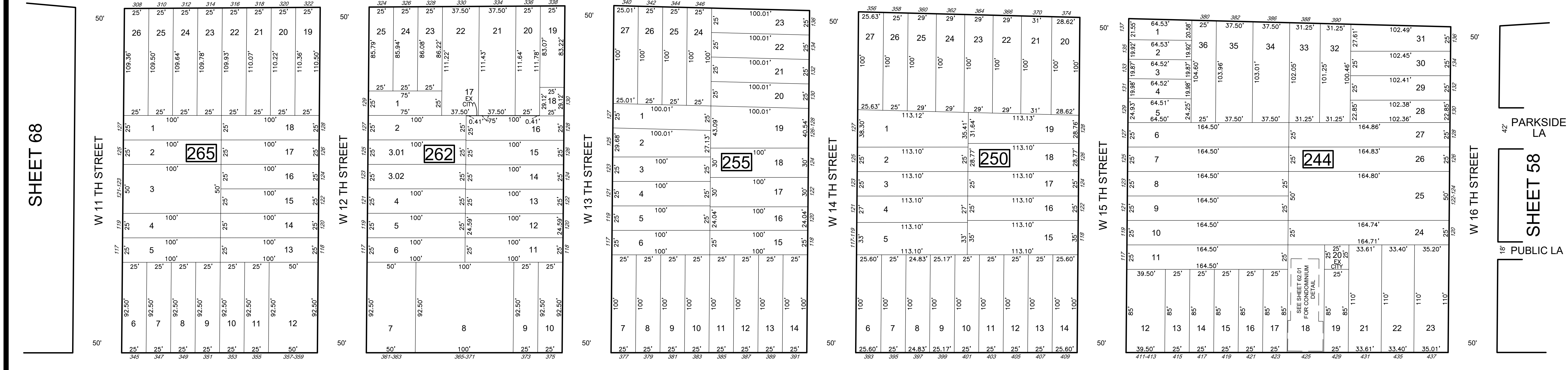

JOHN F. KENNEDY MEMORIAL BOULEVARD

SHEET 64

SHEET 59

\* THIS SHEET HAS BEEN DRAWN USING COMPUTER AIDED DRAFTING/ DESIGN (CAD/D) AND COORDINATE GEOMETRY (COGO).

REVISIONS				
DATE	BY	LIC.NO	BLOCK	LOT
11/2019	ED CLAY	34842	262	3

THIS MAP HAS BEEN GIVEN A FORMAL CERTIFICATION BY THE DIVISION OF TAXATION ON DECEMBER 3, 2018, SIGNED BY SHELLY REILLY AND LATOYA ROBERTSON ASSIGNED SERIAL NUMBER 1094

**TAX MAP**  
CITY OF BAYONNE

HUDSON COUNTY  
SCALE: 1" = 50'

NEW JERSEY  
DATE: SEPTEMBER 2018

**ED CLAY**  
LICENSED LAND SURVEYOR  
NEW JERSEY LICENSE NO. 34842  
215 BELLEVUE AVE  
HAMMONTON, NEW JERSEY 08037  
COAP# 24GA2797300

TO SHOW CONDITIONS AS OF JANUARY 2023